

EAST COAST SHIELDING

CONNECTOR GASKETS

East Coast Shielding Connector Gaskets are available die-cut from the listed standard materials. These materials cover all types of applications and configurations.

Alumashield Gaskets:

0.020" (0.51) thick silicone or neoprene filled 24 x 24 aluminum screen. Used in applications with joint unevenness up to 0.002" (0.05).

Also available in 0.016" thickness.

150 Series Gaskets:

0.032" (1.57) thick solid silicone with monel wire oriented perpendicular to the gasket surface. Used in applications with joint unevenness up to 0.008" (0.20) which require an environmental or pressure seal. Also available with a pressure sensitive adhesive (PSA) backing.

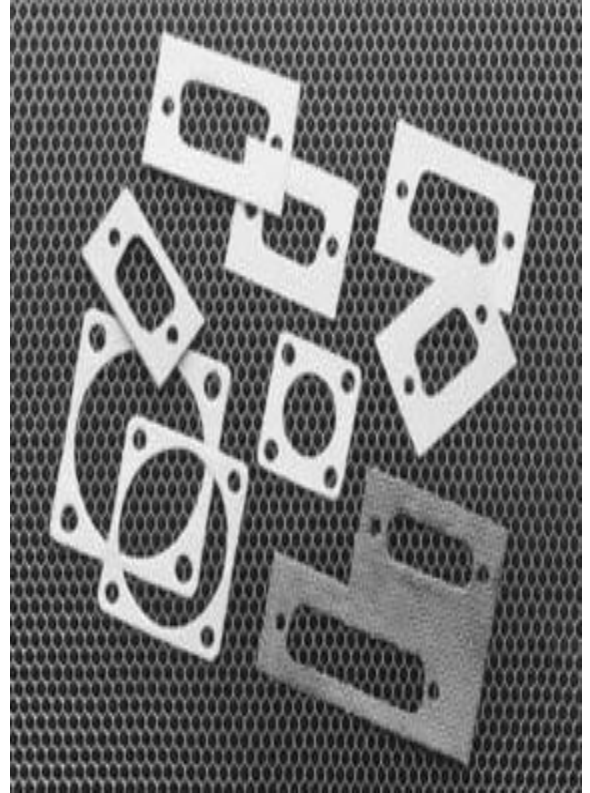

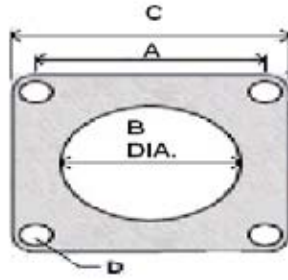

Standard Gaskets

FOR AN, HT & OWL, MIL-C-5015, MS-3102 CONNECTORS

SHELL SIZE	DIMENSIONS				ALUMASHIELD		150 SERIES
	A	B	C	D	NEOPRENE	SILICONE	
8	0.594(15.09)	0.500(12.70)	0.875(22.23)	0.172(4.37)	160-0010	160-0110	150-0159
10	0.719(18.26)	0.625(15.88)	1.000(25.40)	0.172(4.37)	160-0011	160-0111	150-0160
12	0.813(20.65)	0.750(19.05)	1.094(27.79)	0.172(4.37)	160-0012	160-0112	150-0161
14	0.906(23.01)	0.875(22.23)	1.188(30.18)	0.172(4.37)	160-0013	160-0113	150-0162
16	0.969(24.61)	1.000(25.40)	1.281(32.54)	0.172(4.37)	160-0014	160-0114	150-0163
18	1.063(27.00)	1.125(28.58)	1.375(34.93)	0.203(5.16)	160-0015	160-0115	150-0164
20	1.156(29.36)	1.250(31.75)	1.500(38.10)	0.203(5.16)	160-0016	160-0116	150-0165
22	1.250(31.75)	1.375(34.93)	1.625(41.28)	0.203(5.16)	160-0017	160-0117	150-0166
24	1.375(34.93)	1.500(38.10)	1.750(44.45)	0.203(5.16)	160-0018	160-0118	150-0167
28	1.563(39.70)	1.750(44.45)	2.000(50.80)	0.203(5.16)	160-0019	160-0119	150-0168
32	1.750(44.45)	2.000(50.80)	2.250(57.15)	0.219(5.56)	160-0020	160-0120	150-0169
36	1.938(49.23)	2.188(55.58)	2.500(63.50)	0.219(5.56)	160-0021	160-0121	150-0170
40	2.188(55.58)	2.438(61.93)	2.750(69.85)	0.219(5.56)	160-0022	160-0122	150-0171
44	2.375(60.33)	2.781(70.64)	3.000(76.20)	0.219(5.56)	160-0023	160-0123	150-0172
48	2.625(66.68)	3.031(76.99)	3.250(82.55)	0.219(5.56)	160-0024	160-0124	150-0173

Standard Gaskets

FOR PT&PC, JT, MS-3110, MS-3112, MS-3119, MS-3120, MIL-C-26482 CONNECTORS

SHELL SIZE	DIMENSIONS				ALUMASHIELD		150 SERIES
	A	B	C	D	NEOPRENE	SILICONE	
6	0.469(11.91)	0.375(9.53)	0.688(17.48)	0.130(3.30)	160-0025	160-0125	150-0174
8	0.594(14.33)	0.500(12.70)	0.812(20.62)	0.130(3.30)	160-0026	160-0126	150-0175
10	0.719(18.26)	0.625(15.88)	0.938(23.83)	0.130(3.30)	160-0027	160-0127	150-0176
12	0.813(20.65)	0.750(19.05)	1.031(26.19)	0.130(3.30)	160-0028	160-0128	150-0177
14	0.906(23.01)	0.875(22.23)	1.125(28.58)	0.130(3.30)	160-0029	160-0129	150-0178
16	0.969(24.61)	1.000(25.40)	1.219(30.96)	0.130(3.30)	160-0030	160-0130	150-0179
18	1.063(27.00)	1.125(28.58)	1.312(33.32)	0.130(3.30)	160-0031	160-0131	150-0180
20	1.156(29.36)	1.250(31.75)	1.438(36.53)	0.130(3.30)	160-0032	160-0132	150-0181
22	1.250(31.75)	1.375(34.93)	1.563(39.70)	0.130(3.30)	160-0033	160-0133	150-0182
24	1.375(34.93)	1.500(38.10)	1.688(42.88)	0.156(3.96)	160-0034	160-0134	150-0183

Gaskets

FOR BENDIX SERIES SP CONNECTORS

SHELL SIZE	DIMENSIONS				ALUMASHIELD		150 SERIES
	A	B	C	D	NEOPRENE	SILICONE	
6	0.641(16.28)	0.375(9.53)	0.953(24.21)	0.160(4.06)	160-0035	160-0135	150-0184
8	0.734(18.64)	0.500(12.70)	1.047(26.59)	0.160(4.06)	160-0036	160-0136	150-0185
10	0.812(20.62)	0.625(15.88)	1.125(28.58)	0.160(4.06)	160-0037	160-0137	150-0186
12	0.938(23.83)	0.750(19.05)	1.250(31.75)	0.160(4.06)	160-0038	160-0138	150-0187
14	1.031(26.19)	0.875(22.23)	1.344(34.14)	0.160(4.06)	160-0039	160-0139	150-0188
16	1.125(28.58)	1.000(25.40)	1.437(36.50)	0.160(4.06)	160-0040	160-0140	150-0189
18	1.203(30.56)	1.125(28.58)	1.516(38.51)	0.160(4.06)	160-0041	160-0141	150-0190
20	1.297(32.94)	1.250(31.75)	1.672(42.47)	0.160(4.06)	160-0042	160-0142	150-0191
22	1.375(34.93)	1.375(34.93)	1.750(44.45)	0.160(4.06)	160-0043	160-0143	150-0192